

ECLATEC

ELYXE LED

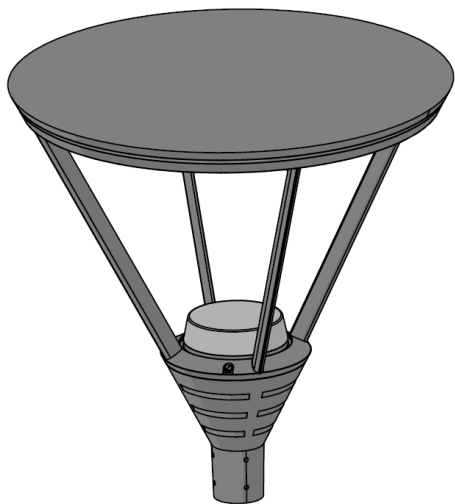

CE

IEC
EN 60598

IP66

RoHS

220-240V 50Hz

IK	kg	SCx	Hmax
08	15,8kg	0,08m ²	12m

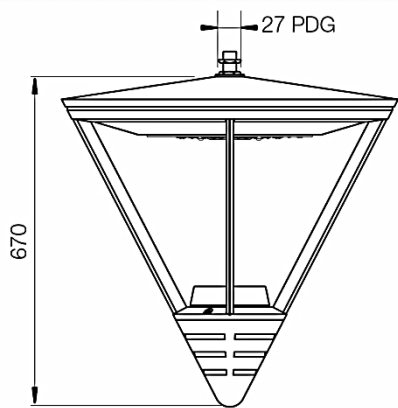
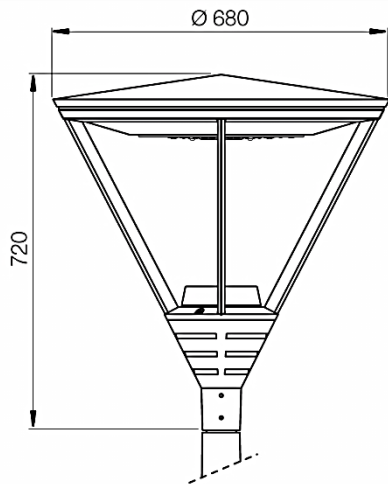

TOP 60

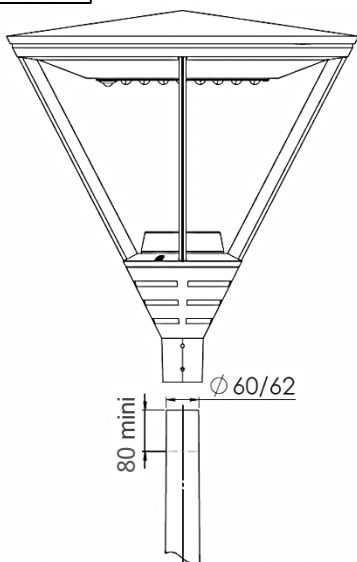
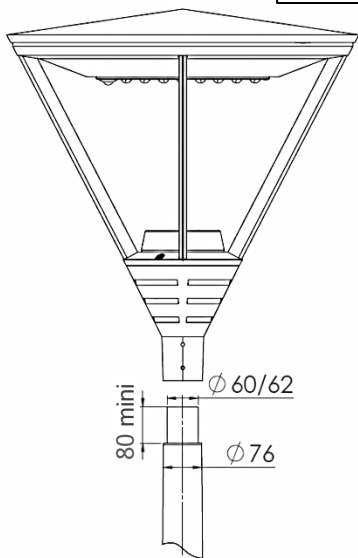

1.1

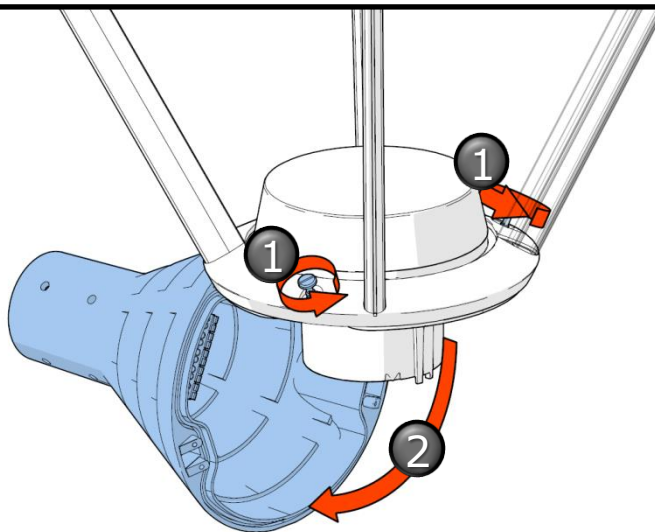

1.2

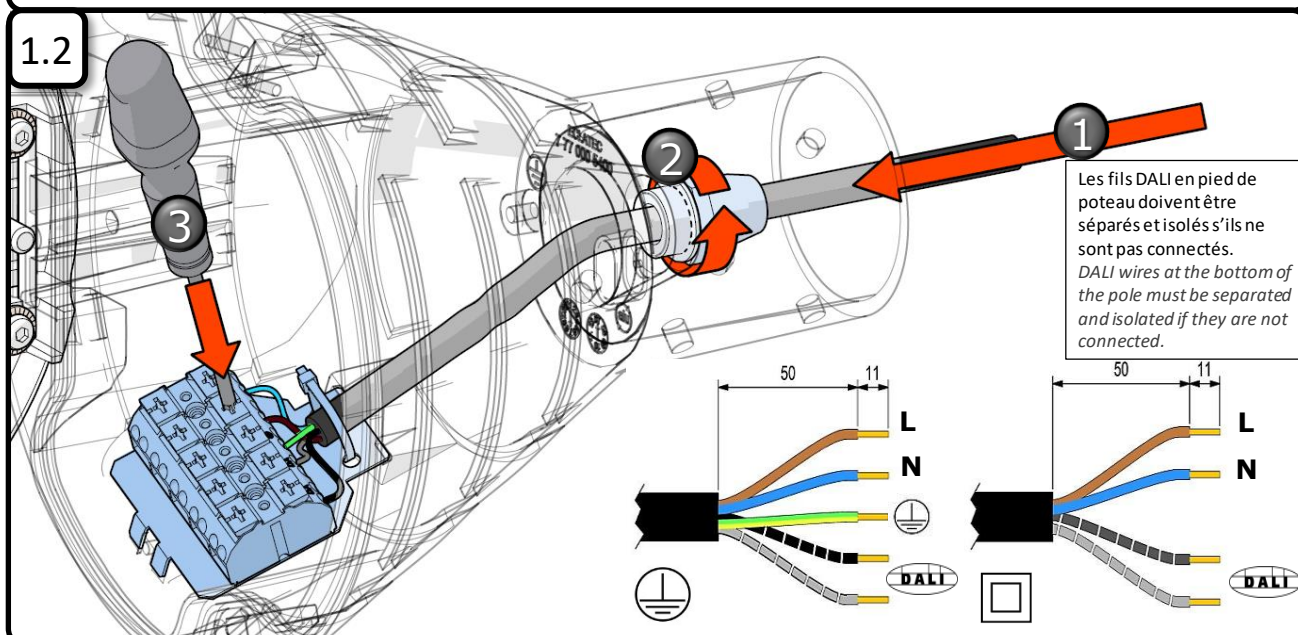

1.3

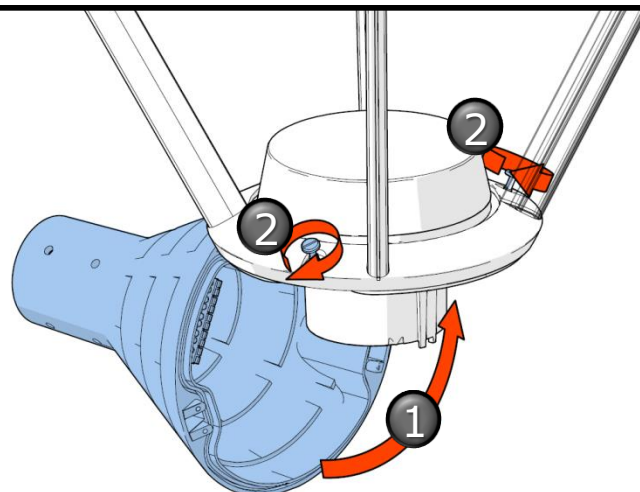

La source lumineuse contenue dans ce luminaire ne doit être remplacée que par le fabricant ou son agent de maintenance ou une personne de qualification équivalente.
The lighting part included in this luminaire must be maintained by the manufacturer, an authorized service agent or a person with similar technical qualification.
Die in der Leuchte beinhalten Lichtquelle soll nur durch den Hersteller oder seinen Wartungsfachmann oder einen Servicetechniker mit einer ähnlichen Qualifikation ersetzt werden.

2.1

Diagram 2.1 illustrates the step of attaching the front of the kayak. The main illustration shows the kayak being lowered into the frame. A red arrow points to the front of the kayak where it meets the frame. A circular inset provides a detailed view of the attachment mechanism, showing a blue strap being secured by a blue buckle. A red arrow in the inset indicates the direction of the strap's movement.

2.2

Diagram 2.2 illustrates the process of attaching the lid to the bin. A red arrow labeled '1' indicates the lid is moved from the bottom to the top. A black arrow labeled '2' points to the hinge mechanism on the inside of the lid.

Autres notices et modes opératoires

