

Berry bracket: steel, Ø 60 mm
 Luminaire fixation: covering or penetrating (standard)
 Penetrating fixing of the bracket in the pole
Finish: polyester powder coating, any colour available
Pole: cylindrical-conical steel Ø 60/62 mm, Ø 76 mm
 and Ø 89 mm

BERRY

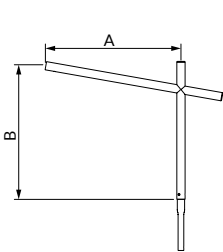

Berry single light
bracket

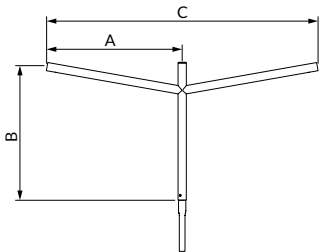

Berry twin light
bracket

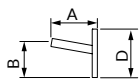

Berry bracket wall
bracket

BERRY	A mm	B mm	C mm	D mm	Tilt	Weight Kg	SCx m²
Single light	505	890	-	-	10°	9.5	0.09
	800	930	-	-	10°	10.2	0.10
	985	975	-	-	10°	10.5	0.11
	1180	1010	-	-	10°	10.5	0.13
	1475	1060	-	-	10°	13	0.13
Twin light	505	890	1010	-	10°	11.8	0.11
	800	930	1600	-	10°	14.2	0.12
	985	975	1970	-	10°	14.7	0.18
	1180	1010	2360	-	10°	16.5	0.18
	1475	1060	2950	-	10°	18.8	0.21
Wall bracket	500	175	-	360	10°	2.6	0.02
Back light	500	175	-	360	10°	2.6	0.02

BERRY BRACKETS

CONFIGURATION EXAMPLES



Chorus Berry



Elipt Berry

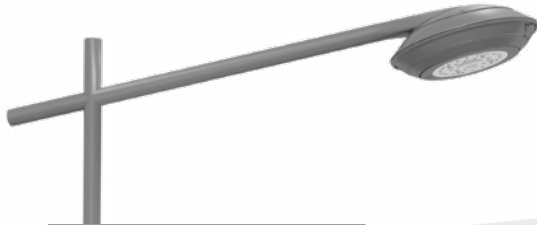

Indice Berry

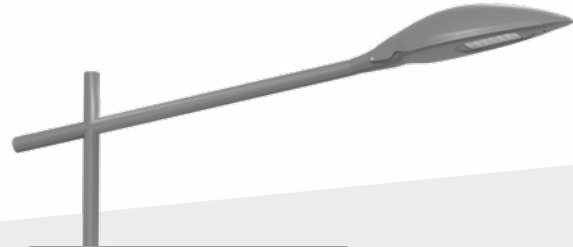

Moana Berry

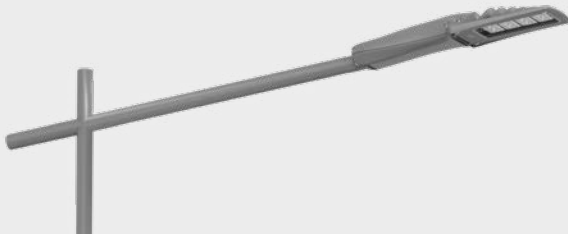

Tilt Berry



Tweet Berry

BERRY

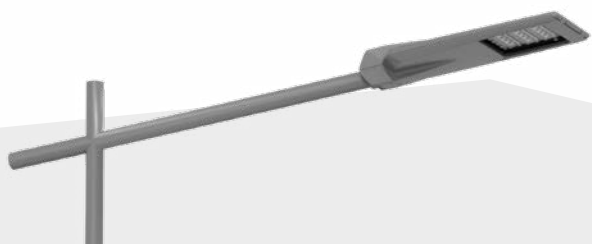

Zelda Berry



Pixel Berry



Tsana Berry



Enza Berry